

NOTES
1. Do not scale from this drawing.

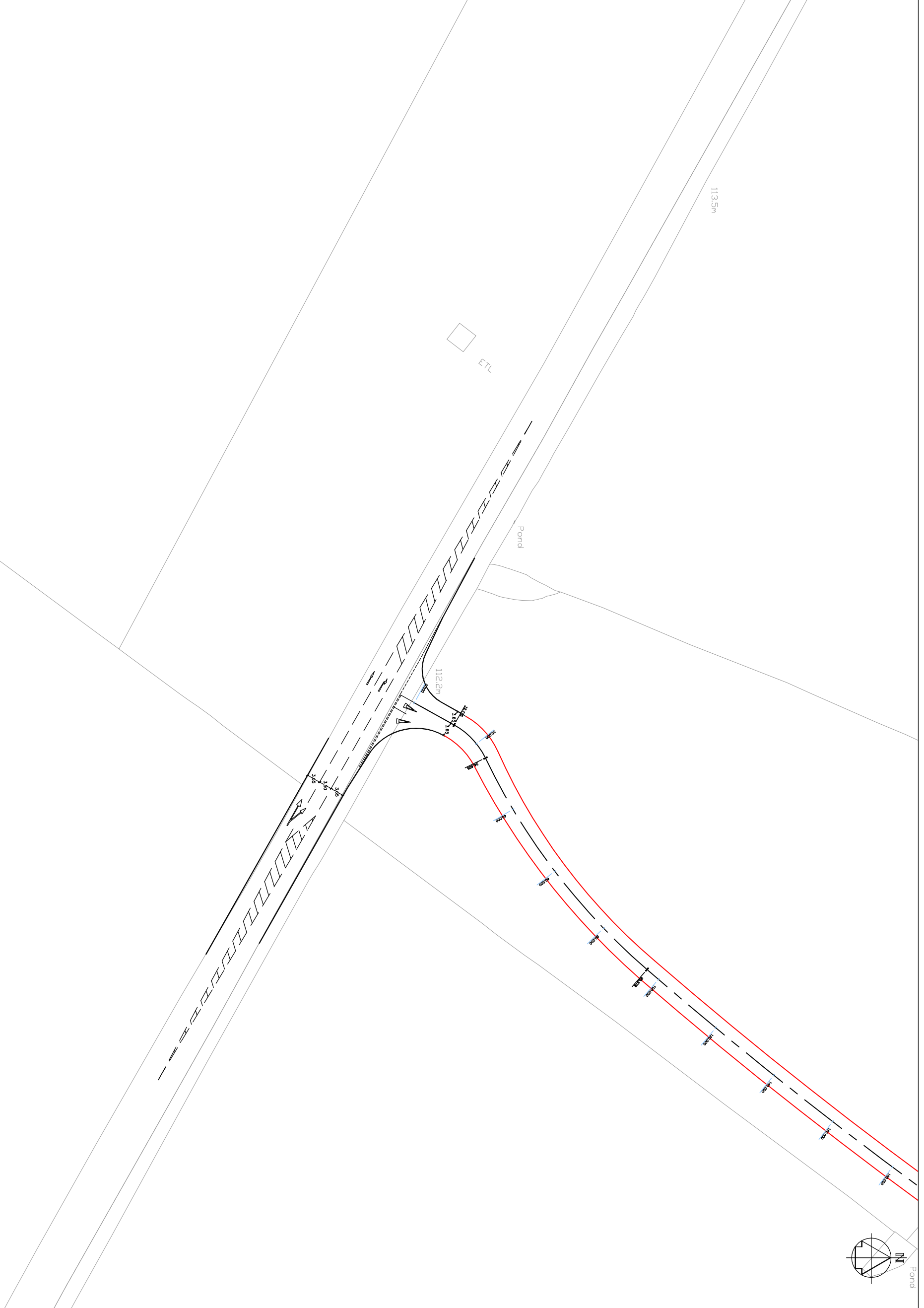
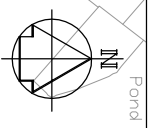

D	JUNCTION LAYOUT UPDATED	MRC	BP	DS	14-01-15
C	JUNCTION DESIGN LOCATION MOVED SOUTHWEST TO SMT WESTBURN	MRC	BP	DS	11-09-14
B	JUNCTION DESIGN LOCATION MOVED NORTHWEST	MRC	BP	DS	13-02-14
REV	DESCRIPTION	ISSN	CHK	APP	DATE

Pell Frischmann
9-10 FREDERICK ROAD EDGBASTON BIRMINGHAM B15 1JD
Telephone +44 (0)121 456 1616
Email: pfr@mfr.com
www.pellfrischmann.com

Client

Project
SOUTH WEST MILTON KEYNES

Drawing Title
WHADDON ROAD ACCESS JUNCTION

Name	Date	Scale
MRC	21-01-13	1:1000 @ A3
Designed	MRC	21-01-13
Checked	-	-
Approved	-	-
Drawing No.	M53295-SK-001	Revision
		D